

Notes

1. Material is RedLINE waterproof expansion joint.
2. This detail illustrates a typical application.
3. Refer to project specific details for more information.
4. The RedLINE joint is monolithic with the building envelope.
(i.e. impervious to all effluents, liquid and gaseous.)

SECTION

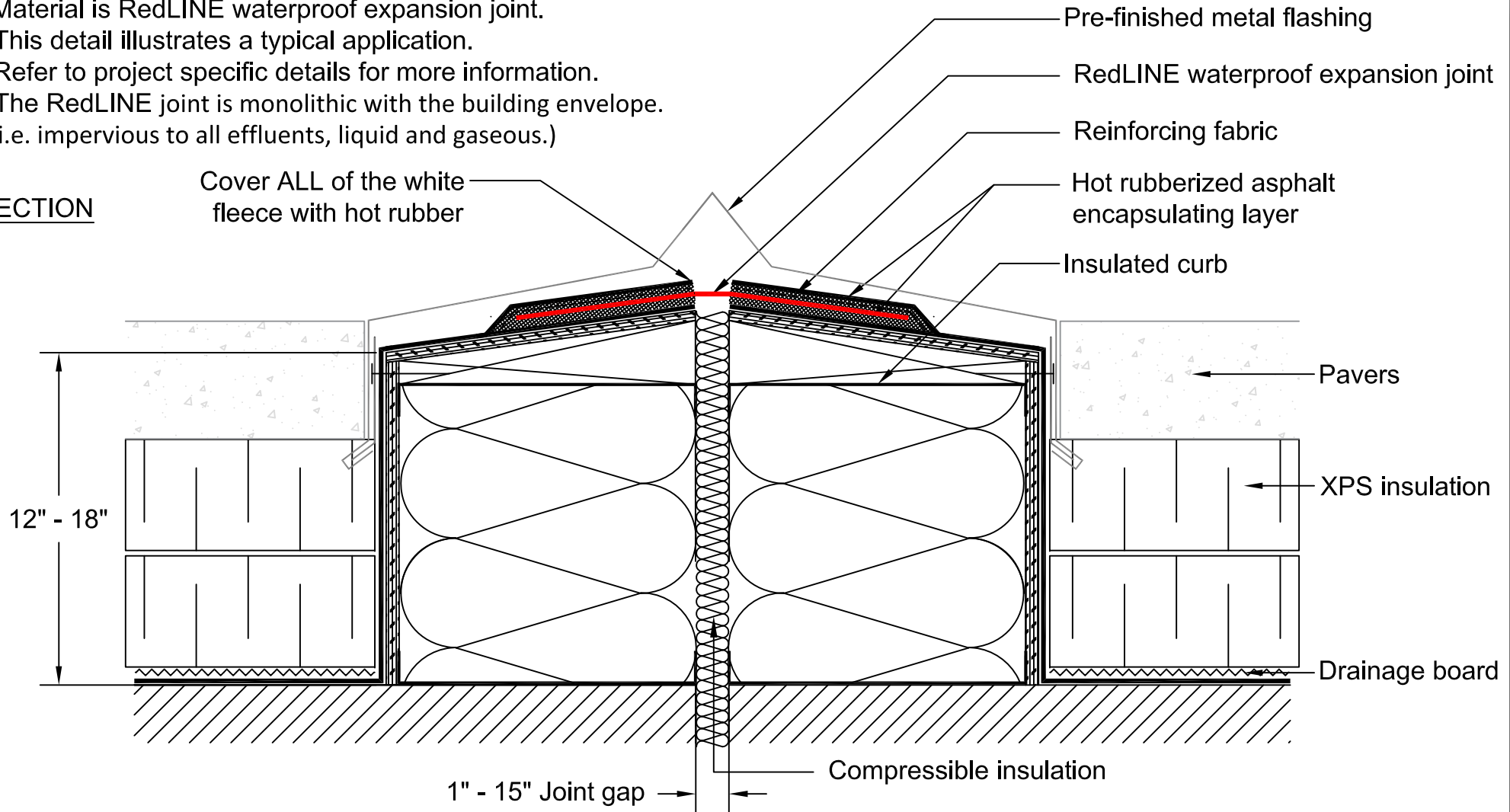

Cover ALL of the white fleece with hot rubber

12" - 18"

1" - 15" Joint gap

Pre-finished metal flashing

RedLINE waterproof expansion joint

Reinforcing fabric

Hot rubberized asphalt encapsulating layer

Insulated curb

Pavers

XPS insulation

Drainage board

Compressible insulation



As a supplier of finished products only, SITURA INC., does not assume responsibility for errors in design, engineering or dimensions. The architect or owner's representative must verify all dimensions and suitability of details. RedLINE®, FlamLINE®, AquaLINE® are registered trade marks of SITURA INC. © Copyright SITURA 2017.

DETAIL NAME:

RedLINE® Waterproof Expansion Joint Installed into Hot Rubberized Asphalt on a curb

DETAIL NUMBER:

RL-HRA-06

SCALE:

NTS

CHECKED BY:

SL

DATE:

09/21/17

SHEET:

1 of 1

APPROVALS AND SIGN OFFS

DESCRIPTION	DATE	SIGNED BY:
REVISION #1		
REVISION #2		
REVISION #3		
REVISION #4		
REVISION #5		